

# FOLDING MEZZANINE LADDER, LAD-FM-72

APPROX WEIGHT: 275.70 lbs.  
 DOES NOT INCLUDE WEIGHT OF POWER OR PACKAGING!!!

\*\*\* ANY ADDITIONS, DELETIONS, OR OMISSIONS MUST BE CORRECTED ON THIS DRAWING AS THIS DRAWING WILL BE CONSIDERED ALL INCLUSIVE \*\*\*

ALL GRAPHICS PROVIDED ARE FOR REFERENCE ONLY. IF CERTAIN DIMENSIONS ARE CRITICAL PLEASE VERIFY THOSE DIMENSIONS WITH YOUR SALESPERSON

FOR INTERNAL USE ONLY PROJECT SIGN OFF	
SALES	
ENG.	
FAB.	
POWER	

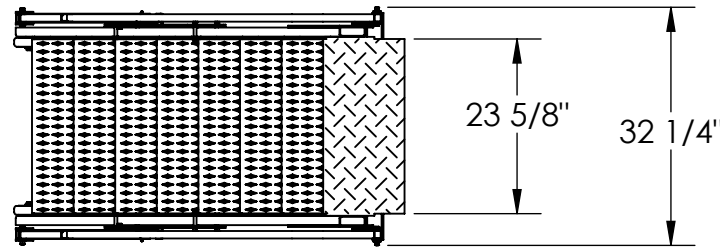

## STANDARD FEATURES

- MODEL NUMBER: LAD-FM-72
- OVERALL WIDTH: 32 1/4"
- USABLE STEP WIDTH: 24 1/4"
- HANDRAIL HEIGHT: 31 5/8"
- STEP MATERIAL: SERRATED STEEL
- STEP DEPTH: 7"
- MAX CAPACITY: 350 LBS.
- MEZZANINE HEIGHT: 72"  
(MEZZANINE HEIGHT TOLERANCE: ± 1/2")
- STEP HEIGHT SPACING: 9"
- EXTENDED LENGTH: 49 3/4"
- COLLAPSED LENGTH: 14 5/8" (APPROX.)
- TOUGH BAKED IN POWDER COATED BLUE AND YELLOW FINISH

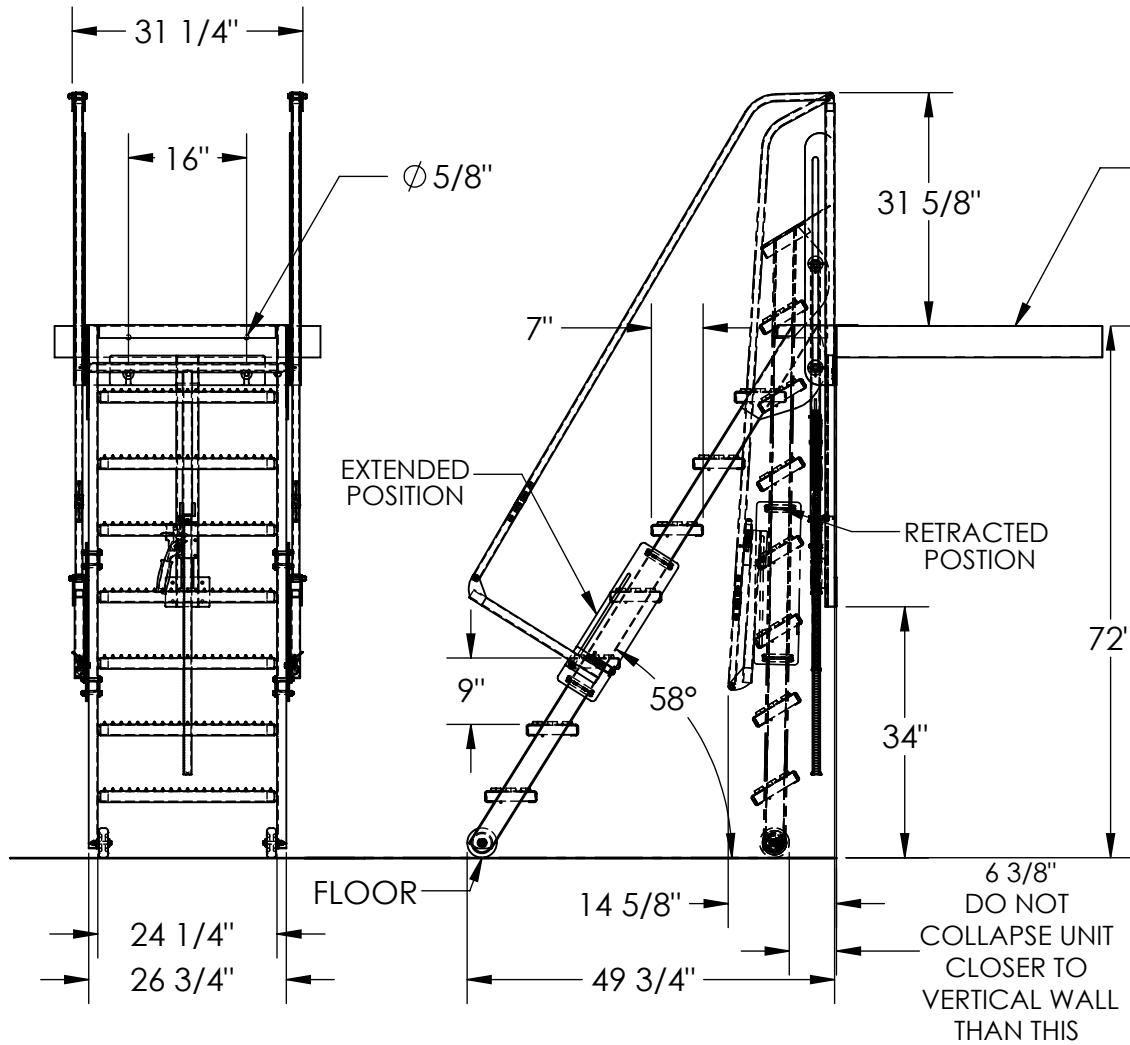

MEZZANINE SHOWN FOR REFERENCE ONLY - NOT INCLUDED

## SPECIAL FEATURES

NONE

IT IS THE CUSTOMER'S RESPONSIBILITY TO MAKE SURE THAT THIS UNIT COMPLIES WITH ALL LOCAL SAFETY LAWS, CODES AND REGULATIONS

DIMENSION TOLERANCE ± 1/4"

<b>APPROVAL</b>	I, THE UNDERSIGNED, AGREE THAT THE PRODUCT AS REPRESENTED SATISFIES DESIGN AND DIMENSION REQUIREMENTS. I ALSO ACKNOWLEDGE MY DUTY TO CONFIRM PRODUCT AND INSTALLATION COMPLIANCE WITH ALL APPLICABLE FEDERAL, STATE AND LOCAL REGULATIONS AND STANDARDS.	
	<b>ANY MODIFIED UNITS ARE NON-RETURNABLE</b>	
	[ ] As drawn [ ] As marked	
	Signed: _____	Date: _____
Printed Name: _____		
LEAD TIME WILL START UPON RECEIPT OF SIGNED APPROVAL DRAWING		

DISTRIBUTOR'S NAME:		P.O.#
VESTIL MANUFACTURING		X
DRAWN BY: KGH		W.O.#
DATE: 11/29/2017		X
REFERENCE: X	SCALE: 1:26	SALES: X
QUOTED LEAD TIME: X	QUOTE # X	FILE NAME: 44-007-676