



**VESTIL MANUFACTURING CORP.**  
 2999 North Wayne Street, P.O. Box 507, Angola, IN 46703  
 Telephone: (260) 665-7586 -or- Toll Free (800) 348-0868  
 Fax: (260) 665-1339  
 www.vestilmfg.com e-mail: [info@vestil.com](mailto:info@vestil.com)

**FDT-22 Drum Lifter  
 Instruction Manual**



**Receiving instructions:**

After delivery, remove the packaging from the product. Inspect the product closely to determine whether it sustained damage during transport. If damage is discovered, record a complete description of it on the bill of lading. If the product is undamaged, discard the packaging.

**NOTE:**

The end-user is solely responsible for confirming that product design, installation, use, and maintenance comply with laws, regulations, codes, and mandatory standards applied where the product is used.

**Table of Contents**

Signal words.....	2
Safe use recommendations.....	2
Labeling diagram.....	2
Exploded parts diagram and bill of materials.....	3
Specifications.....	3
Using the lifter.....	4
Maintenance.....	4
Limited warranty.....	4

## Signal Words:

This manual uses SIGNAL WORDS to draw attention to uses of the product that could result in personal injuries, as well as the probable seriousness of those injuries. Other signal words call attention to uses likely to cause property damage. Signal words used in this manual appear below along with the definition of each word.



Identifies a hazardous situation which, if not avoided, WILL result in DEATH or SERIOUS INJURY. Use of this signal word is limited to the most extreme situations.



Identifies a hazardous situation which, if not avoided, COULD result in DEATH or SERIOUS INJURY.



Indicates a hazardous situation which, if not avoided, COULD result in MINOR or MODERATE injury.



Identifies practices likely to result in product/property damage, such as operation that might damage the product.

## Safe use recommendations:



Vestil strives to identify all foreseeable hazards associated with the use of this product. However, no manual can address every conceivable risk.

- DO NOT open the lifter while a drum is suspended.
- **ALWAYS** inspect the drum lifter before each use. In particular, confirm that the jaws open and close properly, all bolts and nuts are securely fastened, the shackle and shackle pin are in normal condition, and that both lifting arms are undamaged. Tighten the shackle pin before each use.
- Only attach the drum lifter to a properly functioning safety hook, i.e. a hook with a spring latch.
- DO NOT remove or obscure any label. Confirm the placement and legibility of all labels as shown below in "Labeling diagram". If a label is damaged or unreadable, immediately contact Vestil for a replacement. DO NOT use the FDT until the label is replaced.
- ONLY attach the lifter to the top rim of a drum. DO NOT use this lifter to move a drum if the jaws cannot securely clamp the rim.
- DO NOT lift more than 1 drum at a time.
- DO NOT lift a drum lying on its side.
- DO NOT sit or ride on a suspended drum.
- **DO NOT attempt to lift a drum that weighs more than the capacity of the lifter.**
- DO NOT lift a load higher than necessary. (See "Using the lifter" on p. 3).
- DO NOT raise the load over your feet or any other part of your body.
- NEVER lift a drum over yourself or other people.
- The FDT is designed to lift 30 and 55 gallon drums. Do not use it to lift items other than drums.
- Avoid contact with the load while moving it. When moving the drum manually, grasp the handle and stand to the side of the drum. Watch the load at all times.
- DO NOT leave a suspended drum unattended.

## Labeling diagram:

The lifter should always be labeled as shown in the diagram. Replace any label that is missing, damaged, or not easily readable, e.g. faded.

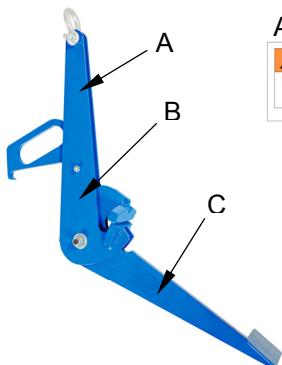

A: label 643

<b>WARNING</b>	<b>ADVERTENCIA</b>	<b>AVERTISSEMENT</b>
KEEP CLEAR OF PINCH POINT	MANTENGASE ALEJADO DEL PUNTO DE CORTE	SE TENIR À DISTANCE DU POINT DE PINCEMENT
643		

C: label 675

<b>WARNING</b>	<b>ADVERTENCIA</b>
<ul style="list-style-type: none"> <li>• DO NOT exceed rated capacity</li> <li>• DO NOT use if damaged, malfunctioning, or missing parts</li> <li>• DO NOT lift people OR lift loads over people</li> <li>• DO NOT raise load higher than necessary</li> <li>• DO NOT leave a suspended load unattended</li> <li>• DO NOT use lifter unless you read and understand the owner's manual</li> <li>• DO NOT alter OR modify lifter</li> <li>• DO NOT remove OR obscure any label</li> <li>• STAY CLEAR of suspended loads</li> <li>• Secure load before using this device</li> </ul>	<ul style="list-style-type: none"> <li>• NO exceda la capacidad tasada</li> <li>• NO USE is las partes estan dañadas, no funcionan correctamente o faltan partes.</li> <li>• NO eleve al personal o eleve cargas sobre el personal</li> <li>• NO eleve la carga mas alto de lo necesario</li> <li>• NO deje desatendida una carga que este suspendida</li> <li>• NO use el elevador a no ser que haya leído y entendido las instrucciones del manual del propietario</li> <li>• NO altere o modifique el elevador</li> <li>• NO quite u oscurezca ninguna etiqueta</li> <li>• MANTENGASE alejado de las cargas suspendidas</li> <li>• Asegure la carga antes de usar este dispositivo</li> </ul>
675	

B: label 1000

Model No. _____	Serial No. _____
No. Modelo _____	No. Serie _____
Capacity _____ lbs.	Lifter Weight _____ lbs.
Capacidad _____ kgs.	Peso del Elevador _____ kgs.
BHT-1 Design Category: B	
BHT-1 Service Category: 1	
BHT-1 Categoría de Diseño B	
BHT-1 Categoría de Servicio: 1	
1000	
Read Owners Manual for product safety warnings	
Lea Manual de Proprietarios para advertencias de seguridad de producto	

# Exploded parts diagram and bill of materials

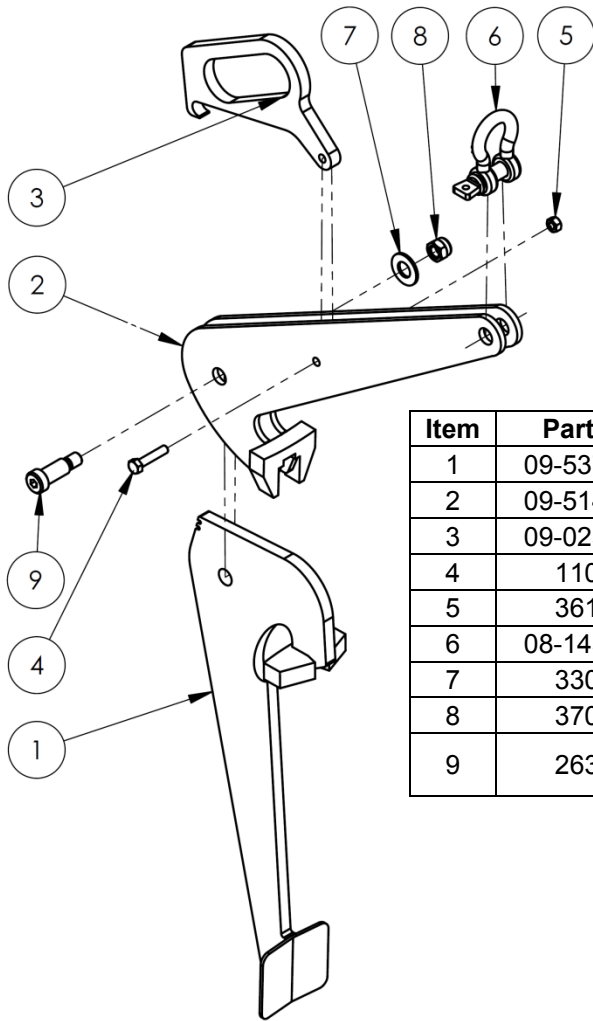

Item	Part no.	Description	Qty.
1	09-537-011	Weldment, latching arm	1
2	09-514-117	Weldment, lifting arm	1
3	09-025-012	Handle, grips, burnout	1
4	11059	Bolt, $\frac{5}{16}$ "-18UNCx1 $\frac{1}{2}$ ", zinc-plated, #2	1
5	36104	Hex nut, grade A, zinc-plated, $\frac{5}{16}$ "-18	1
6	08-145-010	Shackle, $\frac{1}{2}$ " 2-ton	1
7	33090	Flat washer, SAE, $\frac{5}{8}$ "	1
8	37030	Lock nut, $\frac{1}{2}$ "-13	1
9	26370	Socket head shoulder bolt, $\frac{5}{8}$ " x 1 $\frac{1}{4}$ " long with $\frac{5}{16}$ " hex, $\frac{1}{2}$ "-13 UNC threads	1

## Specifications:

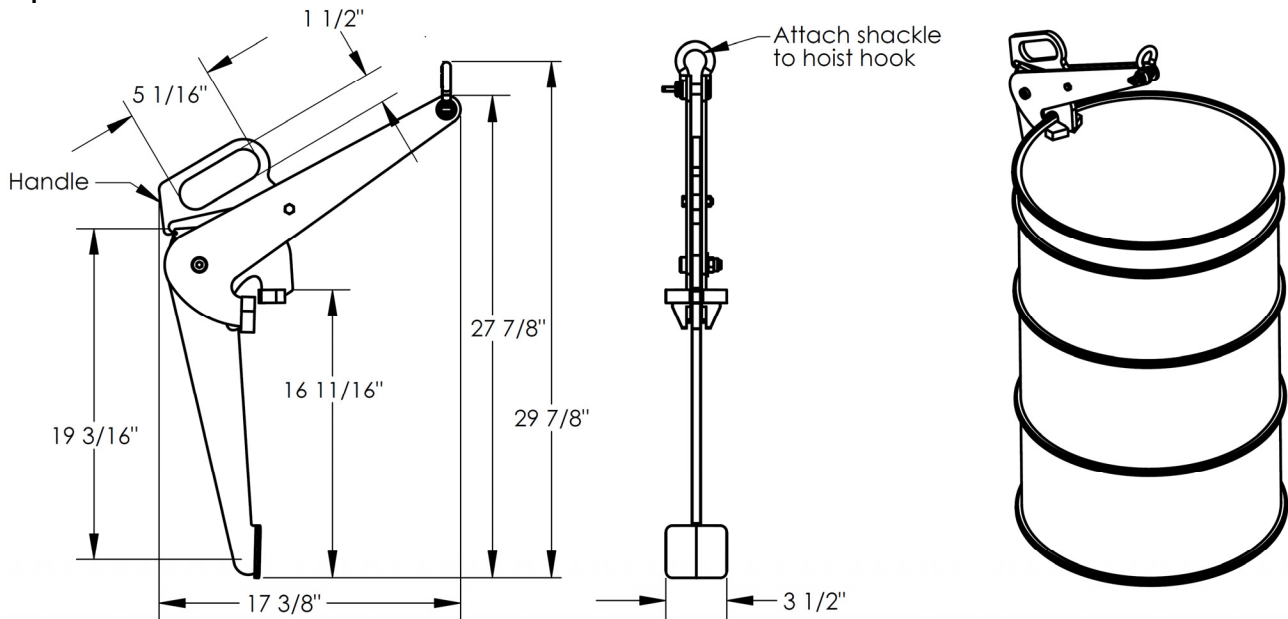

Works with 30gal. and 55gal. steel drums  
Capacity = 1,000 lb.

## Using the lifter:

**Step 1:** Make sure that the shackle pin is securely fasten to the shackle. Then, attach the shackle to the safety hook your hoist or other lifting device.

**Step 2:** Position the lifter above the drum. Open the jaws and lower the FDT over the top/lid of the drum. Unhook the handle from the latching arm to open the jaws.

**Step 3:** Clamp the lip of the drum between the jaws. Make sure that the lower jaw is underneath the rim. Lift the end of the lifting arm and raise the hoist just enough to tighten the clamp on the rim, but not to raise the drum.

**Step 4:** Test the contact between the rim of the drum and the lifter. Stand approximately arm's length from the drum and grasp the handle; then raise the drum just a few inches above the ground.

If you are using a forklift instead of an overhead hoist, observe all procedures applied to the use of forklift attachments at your worksite.

Watch the drum and lifter for approximately 10 seconds to be certain that the lifter has an adequate bite on the rim. If the bite is adequate, proceed to the next step.

**Step 5:** Transport the drum to the desired location.

- a. **Overhead hoist:** Lift the drum ~ 5-6 inches above the ground. Stand to the side of the drum and stabilize it by grasping the handle. Minimize drum swing by moving the drum *slowly*.
- b. **Forklift:** drive slowly, particularly while turning. The drum will tend to swing opposite the direction of a turn, so reduce speed during all turns. The drum will swing out in front of the forklift during braking. Apply the brakes gradually to minimize

**Step 6:** Before lowering the drum, make sure that it is not swinging or spinning. Slowly lower the drum until there is slack in the hoist chain.

**Step 7:** Press the lifting arm down to open the jaws. Then, disengage the FDT from the drum lip.

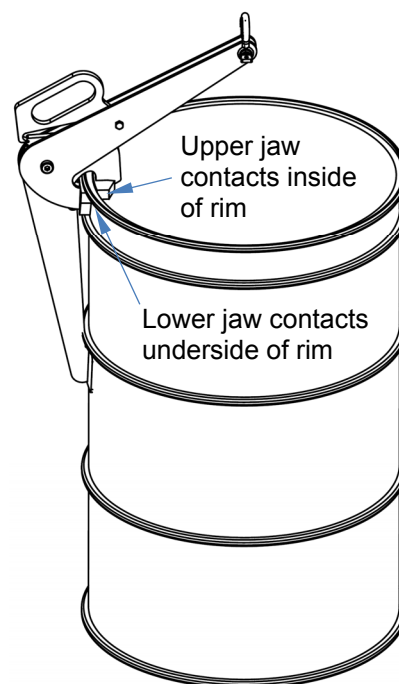
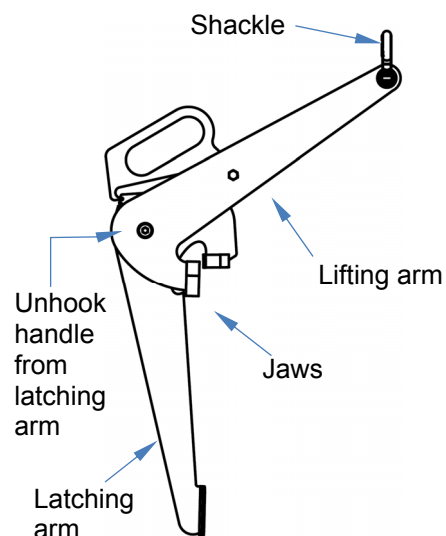

## Maintenance:

Before using the lifter for the first time, make a written record of its appearance. Include observations about pivot point hardware, the jaws, the shackle and shackle pin, and the arms. This record establishes "normal condition". During future inspections, compare your observations to the written record to determine if the unit is in normal condition. **DO NOT** use the FDT unless it is in normal condition.

Visually examine the drum lifter before it is used for the first time, as well as before and during each lift. In particular, examine:

1. Shackle and shackle pin: make sure that the shackle and pin are not bent, cracked, or severely worn. The opening in the lifting arm for the shackle should not be stretched, bent or cracked.
2. Lifting arm and latching arm: confirm that both arms are in normal condition. Jaw parts should be solidly welded to the arms.
3. Make a dated record of the repairs, adjustments and/or replacements made.

If repairs are necessary, only install manufacturer-approved replacement parts. Deformities, cracks, and severe wear of either arm warrants immediate replacement of the entire unit.

## LIMITED WARRANTY

Vestil Manufacturing Corporation (“Vestil”) warrants this product to be free of defects in material and workmanship during the warranty period. *Our warranty obligation is to provide a replacement for a defective original part if the part is covered by the warranty, after we receive a proper request from the warrantee (you) for warranty service.*

### Who may request service?

Only a warrantee may request service. *You are a warrantee if* you purchased the product from Vestil or from an authorized distributor AND Vestil has been fully paid.

### What is an “original part”?

An original part is a part used to make the product as shipped to the warrantee.

### What is a “proper request”?

A request for warranty service is proper if Vestil receives: 1) a photocopy of the Customer Invoice that displays the shipping date; AND 2) a written request for warranty service including your name and phone number. Send requests by any of the following methods:

<u>Mail</u>	<u>Fax</u>	<u>Email</u>
Vestil Manufacturing Corporation 2999 North Wayne Street, PO Box 507 Angola, IN 46703	(260) 665-1339 <u>Phone</u> (260) 665-7586	sales@vestil.com

In the written request, list the parts believed to be defective and include the address where replacements should be delivered.

### What is covered under the warranty?

After Vestil receives your request for warranty service, an authorized representative will contact you to determine whether your claim is covered by the warranty. Before providing warranty service, Vestil may require you to send the entire product, or just the defective part or parts, to its facility in Angola, IN. The warranty covers defects in the following original dynamic components: motors, hydraulic pumps, electronic controllers, switches and cylinders. It also covers defects in original parts that wear under normal usage conditions (“wearing parts”), such as bearings, hoses, wheels, seals, brushes, and batteries.

### How long is the warranty period?

The warranty period for original dynamic components is 90 days. For wearing parts, the warranty period is 90 days. The warranty periods begin on the date when Vestil ships the product to the warrantee. If the product was purchased from an authorized distributor, the periods begin when the distributor ships the product. Vestil may, at its sole discretion, extend the warranty periods for products shipped from authorized distributors by *up to* 30 days to account for shipping time.

### If a defective part is covered by the warranty, what will Vestil do to correct the problem?

Vestil will provide an appropriate replacement for any *covered* part. An authorized representative of Vestil will contact you to discuss your claim.

### What is not covered by the warranty?

1. Labor;
2. Freight;
3. Occurrence of any of the following, which automatically voids the warranty:
  - Product misuse;
  - Negligent operation or repair;
  - Corrosion or use in corrosive conditions;
  - Inadequate or improper maintenance;
  - Damage sustained during shipping;
  - Accidents involving the product;
  - Unauthorized modifications: DO NOT modify the product IN ANY WAY without first receiving written authorization from Vestil. Modification(s) might make the product unsafe to use or might cause excessive and/or abnormal wear.

### Do any other warranties apply to the product?

Vestil Manufacturing Corp. makes no other express warranties. All implied warranties are disclaimed to the extent allowed by law. Any implied warranty not disclaimed is limited in scope to the terms of this Limited Warranty.

