

PORTABLE RAIL CART - PRAIL-CT-1

APPROX WEIGHT: 264.74 lbs.
 DOES NOT INCLUDE WEIGHT OF POWER OR PACKAGING!!!

*** ANY ADDITIONS, DELETIONS, OR OMISSIONS MUST BE CORRECTED ON THIS DRAWING AS THIS DRAWING WILL BE CONSIDERED ALL INCLUSIVE ***
 ALL GRAPHICS PROVIDED ARE FOR REFERENCE ONLY. IF CERTAIN DIMENSIONS ARE CRITICAL PLEASE VERIFY THOSE DIMENSIONS WITH YOUR SALESPERSON

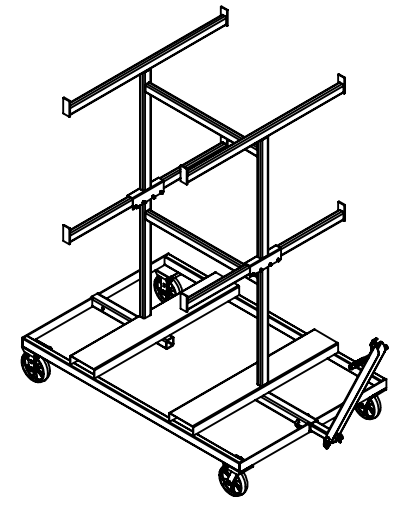
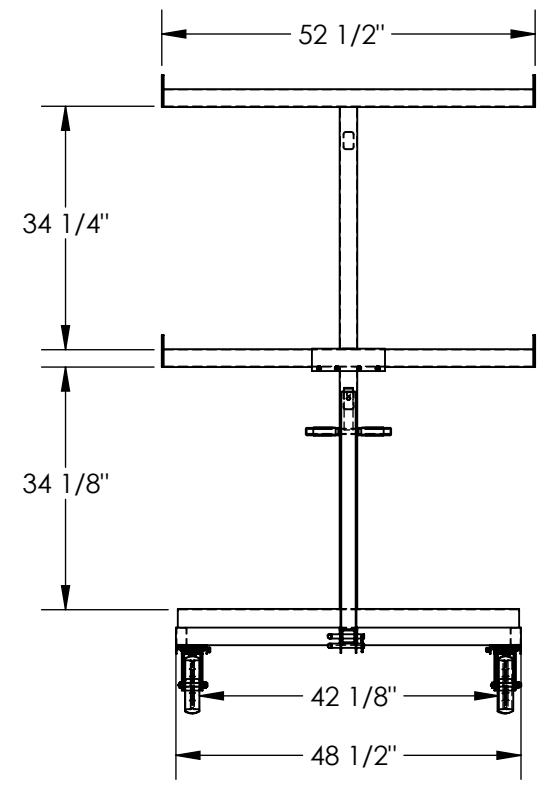
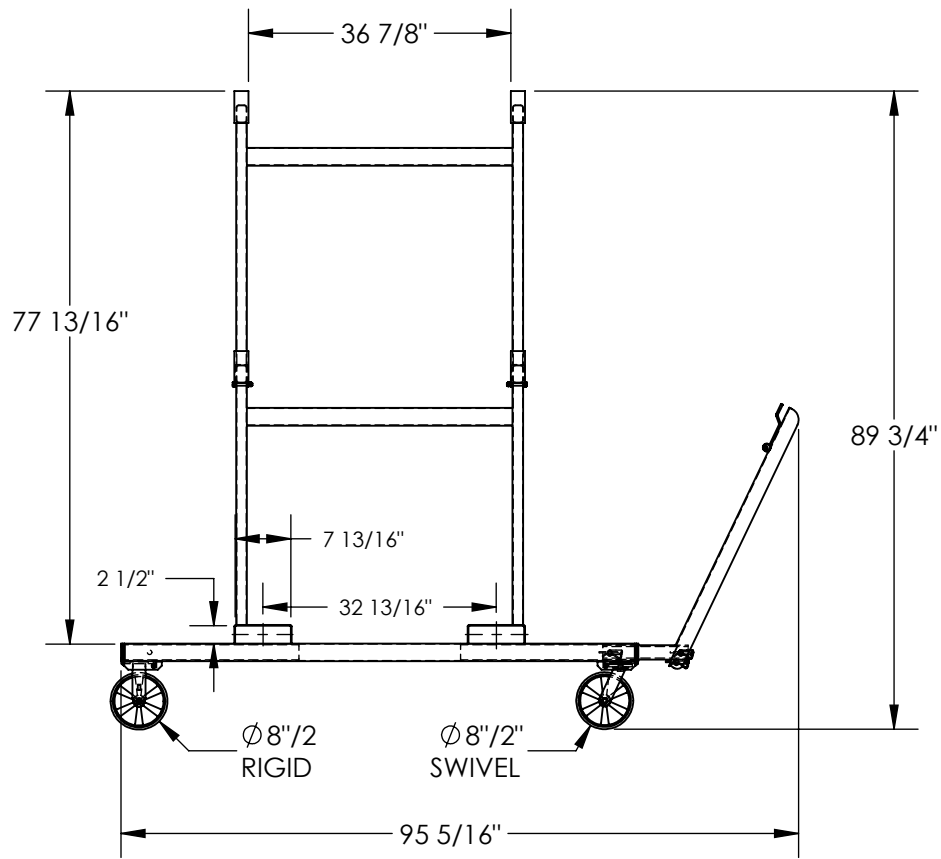

DIMENSION TOLERANCE ± 1/4"

STANDARD FEATURES

- MODEL NUMBER IS PRAIL-CT-1
- OVERALL WIDTH IS 52 1/2"
- USABLE WIDTH IS 48 1/2"
- USABLE HEIGHT IS 77 13/16"
- OVERALL HEIGHT IS 89 3/4"
- USEABLE FORK POCKET 2 1/2" x 7 13/16"
- 32 13/16" FORK POCKET CENTERS
- OVERALL UNIFORM CAPACITY IS 3,500 LB
- CAPACITY PER ARM PAIR IS 875 LB
- REMOVABLE HITCH CAN BE MOUNTED TO EITHER END
- CASTER SIZE = 8" X 2"

SPECIAL FEATURES

NONE

APPROVAL	I, THE UNDERSIGNED, AGREE THAT THE PRODUCT AS REPRESENTED SATISFIES DESIGN AND DIMENSION REQUIREMENTS. I ALSO ACKNOWLEDGE MY DUTY TO CONFIRM PRODUCT AND INSTALLATION COMPLIANCE WITH ALL APPLICABLE FEDERAL, STATE AND LOCAL REGULATIONS AND STANDARDS.	
	ANY MODIFIED UNITS ARE NON-RETURNABLE	
	[] As drawn [] As marked	
	Signed: _____ Date: _____	
Printed Name: _____		
<i>LEAD TIME WILL START UPON RECEIPT OF SIGNED APPROVAL DRAWING</i>		

FOR INTERNAL USE ONLY PROJECT SIGN OFF	
SALES	
ENG.	
FAB.	
POWER	

DISTRIBUTOR'S NAME:		P.O.#
VESTIL MANUFACTURING		X
DRAWN BY: B.HORN		DATE: 04/28/15
REFERENCE: X		SALES: X
QUOTED LEAD TIME: X		SCALE: 1:27
QUOTE # X		FILE NAME: 16-007-413